



# SCD - Sense | Connect | Detect

Industry 4.0 out of the box

## PART NO | 0273 600 074-001

The Sense Connect Detect (SCD) enables companies to get started easily with industry 4.0. As a cost-effective, reliable (IP67) and easy-to-install solution, the sensor device attaches to almost any machine and component. The data acquisition process can start right away and reports wirelessly via Bluetooth low energy. The acquired data is visualized via the SCD mobile App that can be operated without prior knowledge.

### BUILT-IN SENSORS



Accelerometer



Light sensor



Magnetometer



Temperature sensor

### APPLICATION ADVANTAGES

- ▶ Extremely simple plug and play sensor
- ▶ Provides first insight on the machine response, as well as raw data for further processing
- ▶ Multiple use device with non-rechargeable battery



### SCOPE OF DELIVERY

- ▶ SCD device & built-in battery
- ▶ Quick Start Guide
- ▶ Packaging unit consists of 10 devices

### DOWNLOAD

- ▶ App: SCD Sensor

### OPERATING CONDITIONS

- ▶ Operating temperature range -20°C ... +85°C
- ▶ Recommended storage temperature +10°C ... +30°C
- ▶ Humidity range 0% rH ... 100 % rH

### MEASUREMENT RANGES & ACCURACIES

Sensor	Measurement Range	Accuracy
▶ Acceleration	± 200g	± 10 %
▶ Magnetometer	± 1300 µT (X, Y-Axis); ± 2500 µT (Z-Axis)	± 5 %
▶ Temperature	-20°C ... +85°C	± 0.25 °C
▶ Light	0 ... 188000 Lux	± 15 %

**Note:** specified accuracies refer to the inbuilt sensors. The accuracy and responsiveness of the SCD110 might deviate from sensor specifications dependent on installation conditions and environmental influences.

## RESOLUTION

▶ Acceleration	0.1 g
▶ Magnetometer	10 $\mu$ T
▶ Temperature	0.1°C
▶ Light	1 lux



**BOSCH**  
Invented for life

## DEVICE SPECIFICATION

▶ Dimension (L x W x H)	70.9 mm x 62 mm x 11.3 mm
▶ Weight	21 g
▶ Power supply	non-rechargeable CR2450 3V Li/MnO <sub>2</sub> , 490mAh
▶ Battery life	up to 2 years depending on configuration and use
▶ Enclosure protection class	IP 67
▶ Electrical protection class	III
▶ Sampling rates (Hz)	Acceleration : 400, 800, 1600, 3200, 6400 Magnetometer: 10 Temperature: 0.05 Light: 1.25, 10
▶ Memory capacity	1 MB
▶ BLE Activation	In Standby: On push button During operation: Automatic activation every 3 hours
▶ Country certifications	CE, USA, Canada - <i>for other countries ask our support</i>
▶ Environmental certifications	RoHS, REACH

## COMMUNICATION

▶ Bluetooth Low Energy	
▶ Range	up to 40 m (dependent on external influences)

## USER INTERFACE

▶ SCD Sensor App	free smartphone application for configuration, read out and visualization
------------------	---

## DRAWING AND DIMENSIONS

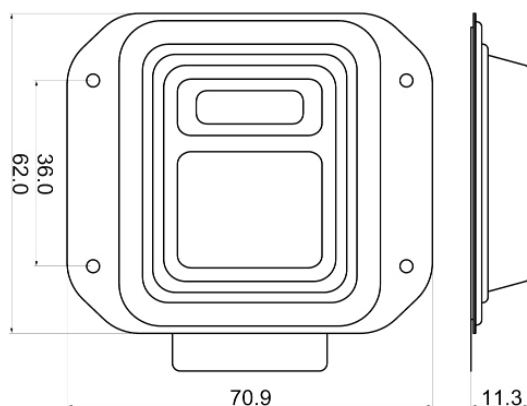

## GET IN CONTACT WITH US!

**E-Mail:** [support@bosch-connectivity.com](mailto:support@bosch-connectivity.com)

**Website:** [www.bosch-connectivity.com/SCD](http://www.bosch-connectivity.com/SCD)

Technical data subject to modification without notice.

© Bosch Connected Devices and Solutions GmbH 2019. All rights reserved, also regarding and disposal, exploitation, reproduction, editing, distribution, as well as in the event of application for industrial property rights. August, 21, 2019